



APARTMENTS 2808, 2908, 3008, 3108, 3208, 3308, 3408, 3508, 3608, 3708,
3808, 3908, 4008, 4108, 4307, 4407, 4507, 4607, 4707, 4807, 4907, 5007, 5107,
5207, 5307, 5407, 5507, 5607, 5707, 5807, 5907, 6007, 6107, 6207, 6307, 6407
INTERNAL AREA = 69m²
TOTAL AREA = 69m² + CARSPACE



2 BED APARTMENT

Levels 28 - 41, 43 - 64



MERITON
MAKING LUXURY APARTMENTS
AFFORDABLE

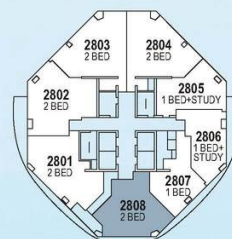

PURCHASERS TAKE NOTE: These floorplans DO NOT FORM PART of the Contract for Sale of any lot within the development. They are INDICATIVE ONLY. The descriptions, layouts and areas set out in this floor plan are subject to change and may not accurately reflect the final design of each unit depicted.

